

A close-up photograph of two hands holding two identical black cylindrical lenses of the MIL3000 test equipment. The lenses are held side-by-side, and their circular openings reveal a glowing green and blue internal light source. The background is dark, making the hands and the glowing lenses the central focus.

**MIL3000 - calibration and test setups**

**Simple to setup and operate, powerful functionality**

- ✓ MIL-STD-461G CS 115 [calibration](#) and [test](#) setups
- ✓ MIL-STD-461G CS 116 [calibration](#) and [test](#) setups 10 kHz – 10 MHz
- ✓ MIL-STD-461G CS 116 [calibration](#) and [test](#) setups 30 MHz – 100 MHz
- ✓ MIL-STD-461F CS 106 [calibration](#) and [test](#) setups
- ✓ MIL-STD-461C CS06 [calibration and test setups](#)
- ✓ DO-160 Section 17 [calibration](#) and [test](#) setups
- ✓ DO-160 Section 19 (spikes) [calibration](#) and [test](#) setups

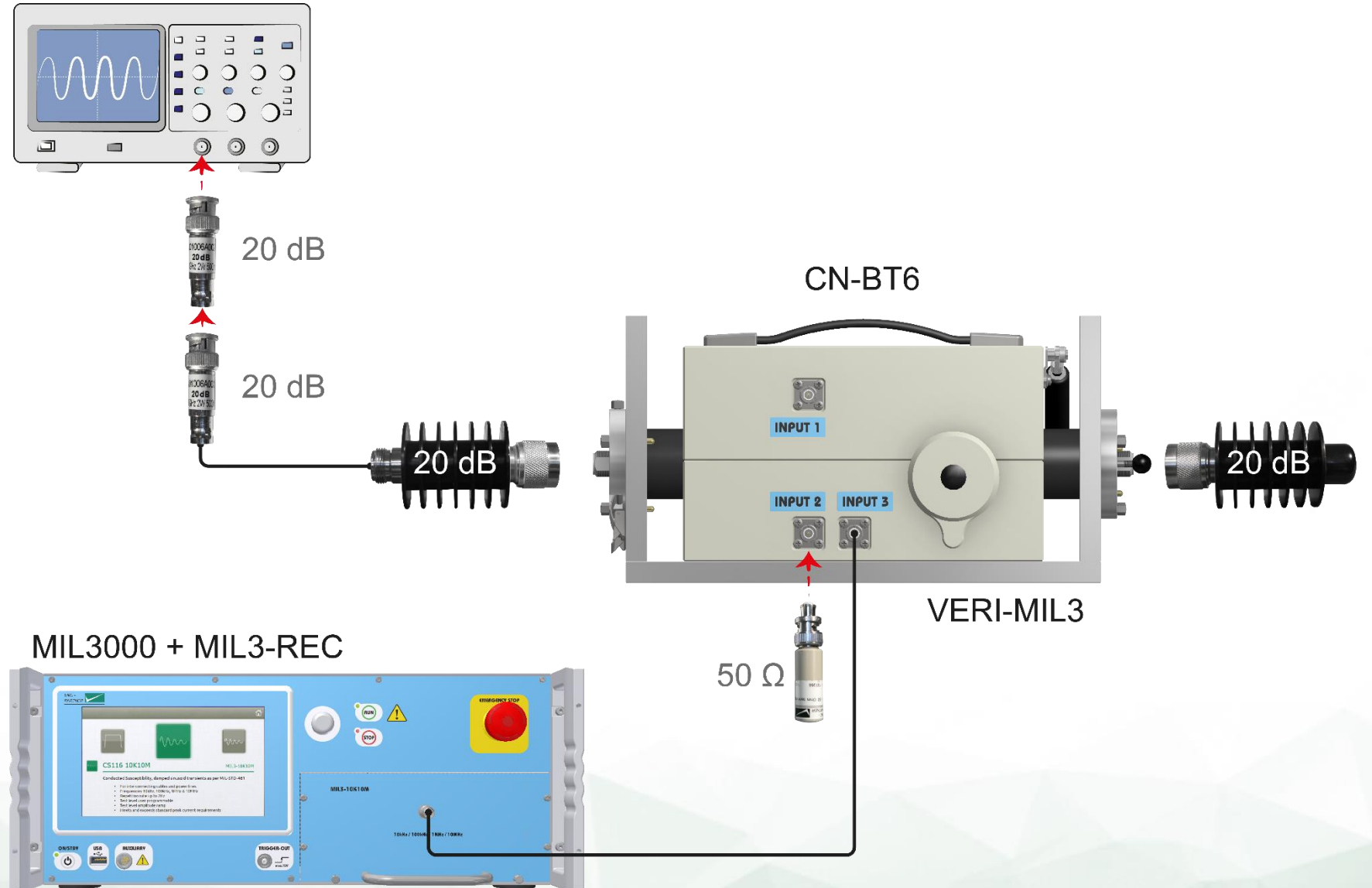

✓ VERI-MIL3 includes both calibration loads (2 x 20 dB/50 Ω) and measurement attenuators (2 x 20 dB/50 Ω)

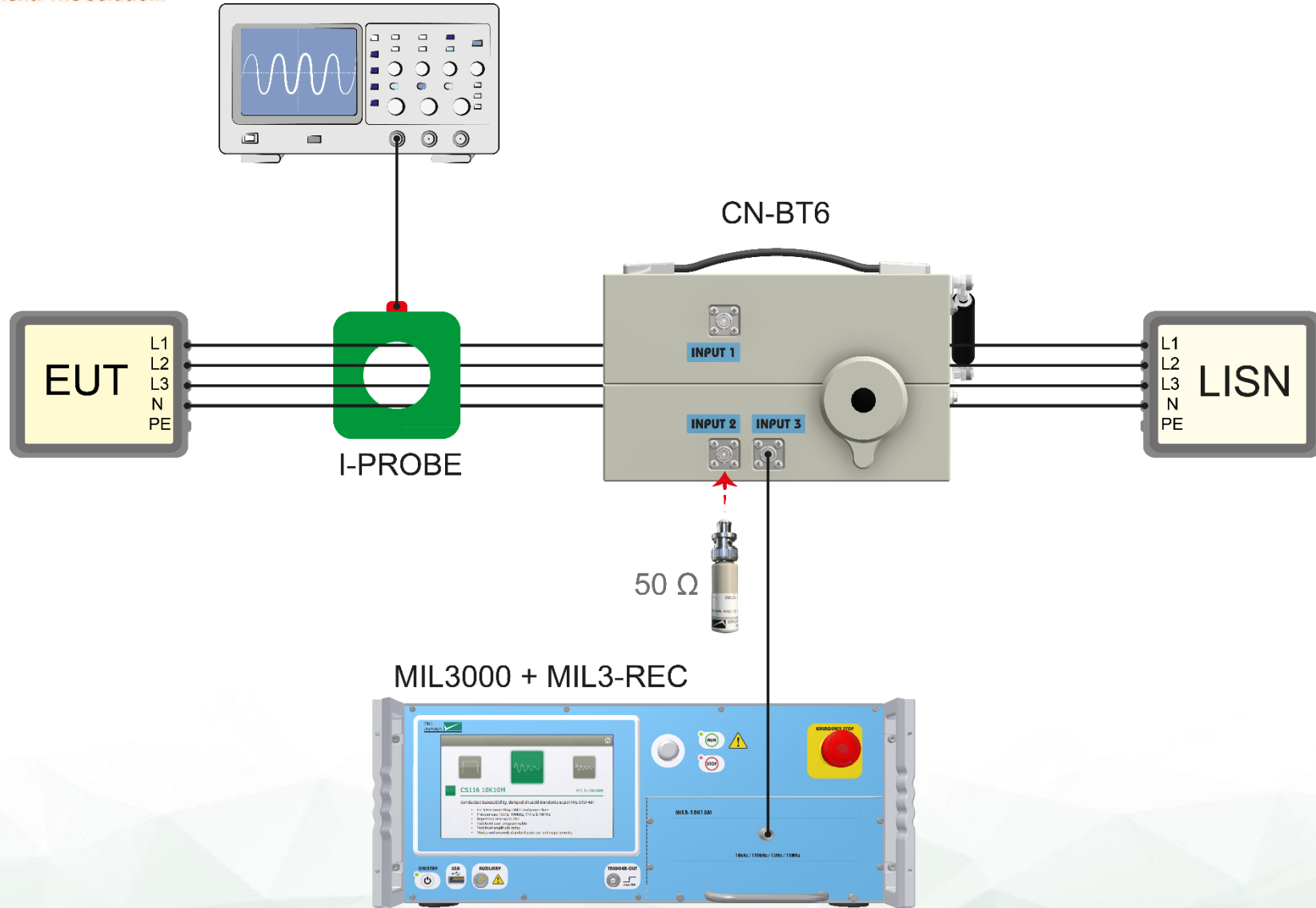

✓ I-PROBE-CS can be used

Overview

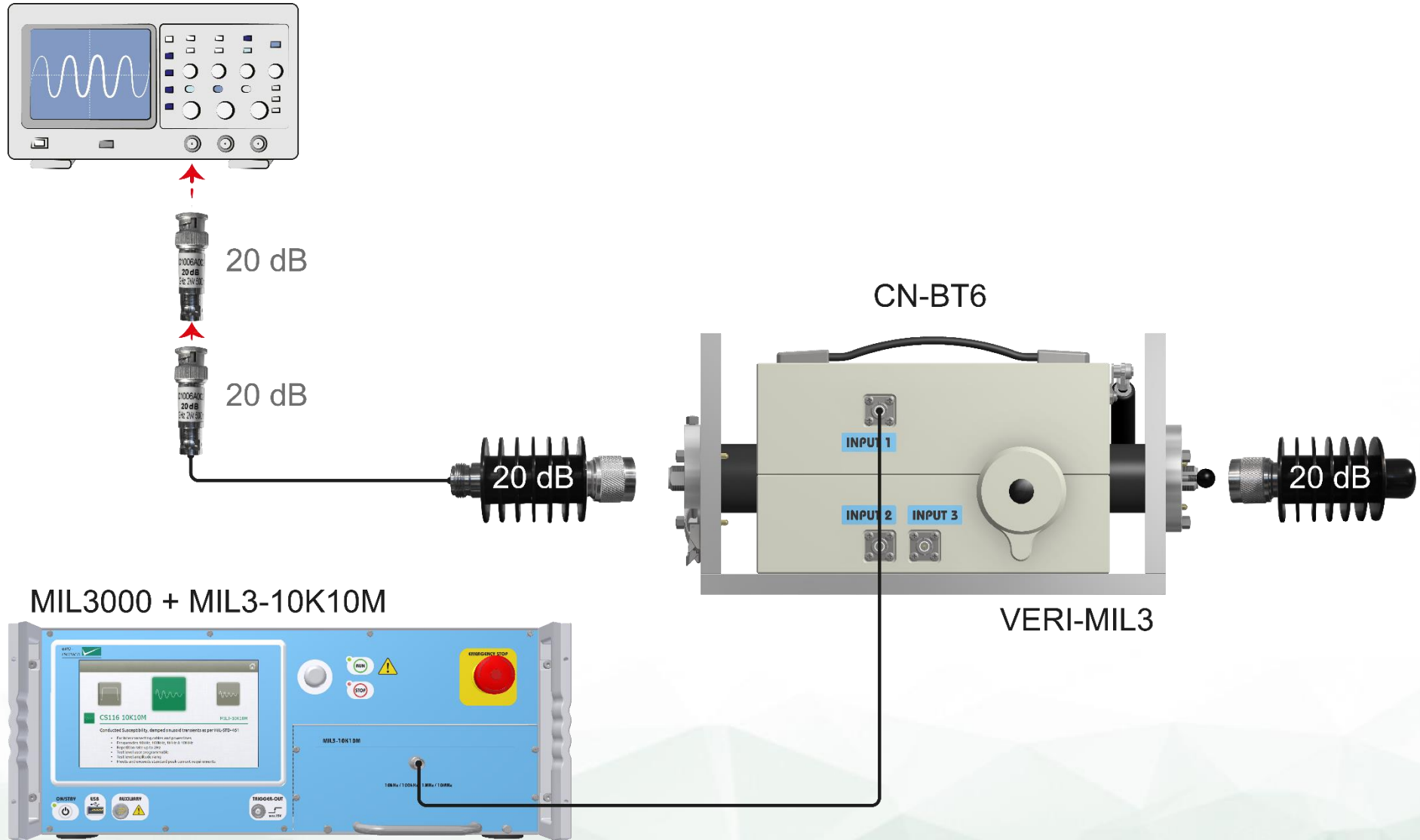

✓ VERI-MIL3 includes both calibration loads (2 x 20 dB/50 Ω) and measurement attenuators (2 x 20 dB/50 Ω)

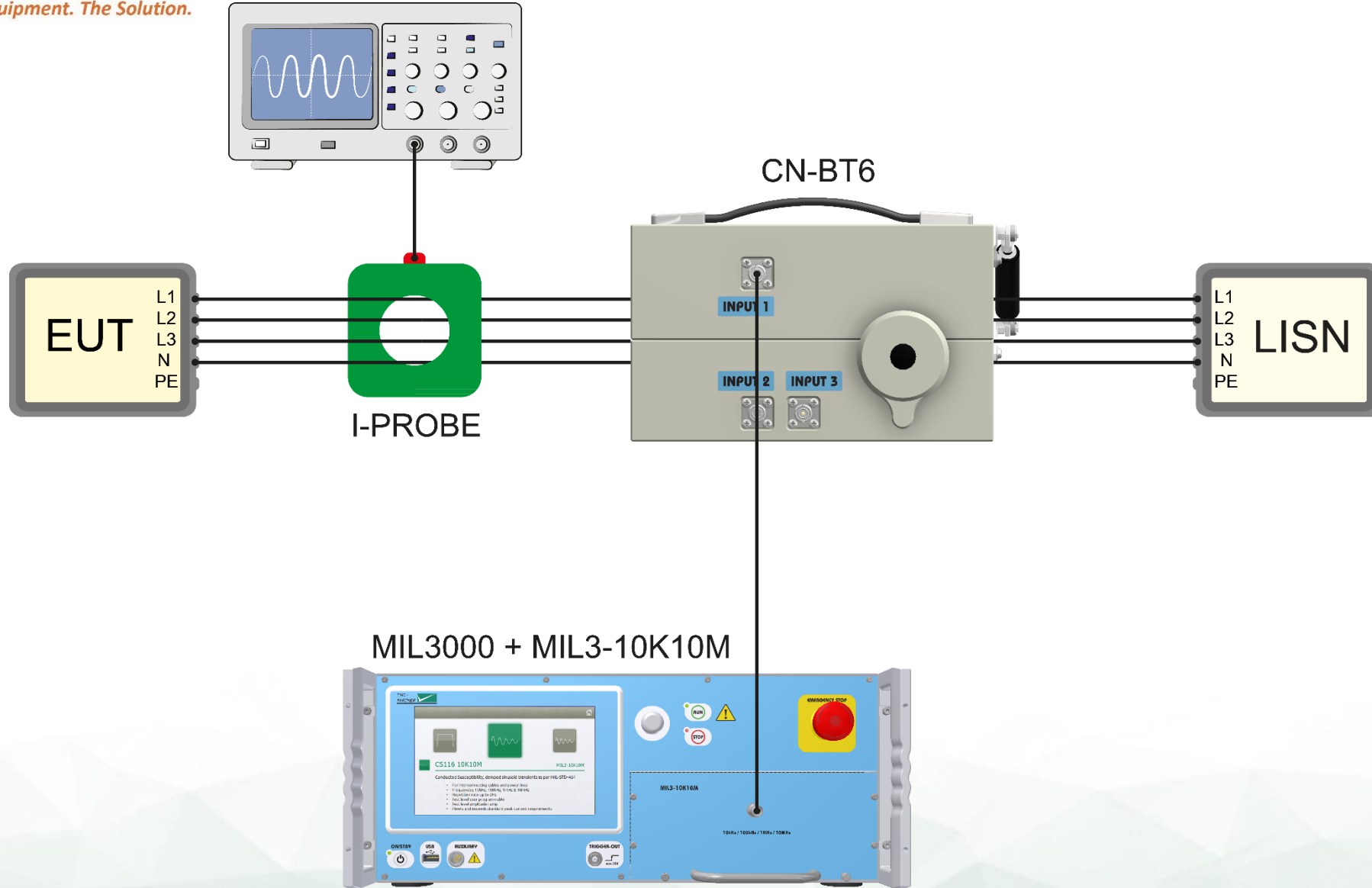

✓ I-PROBE-CS can be used

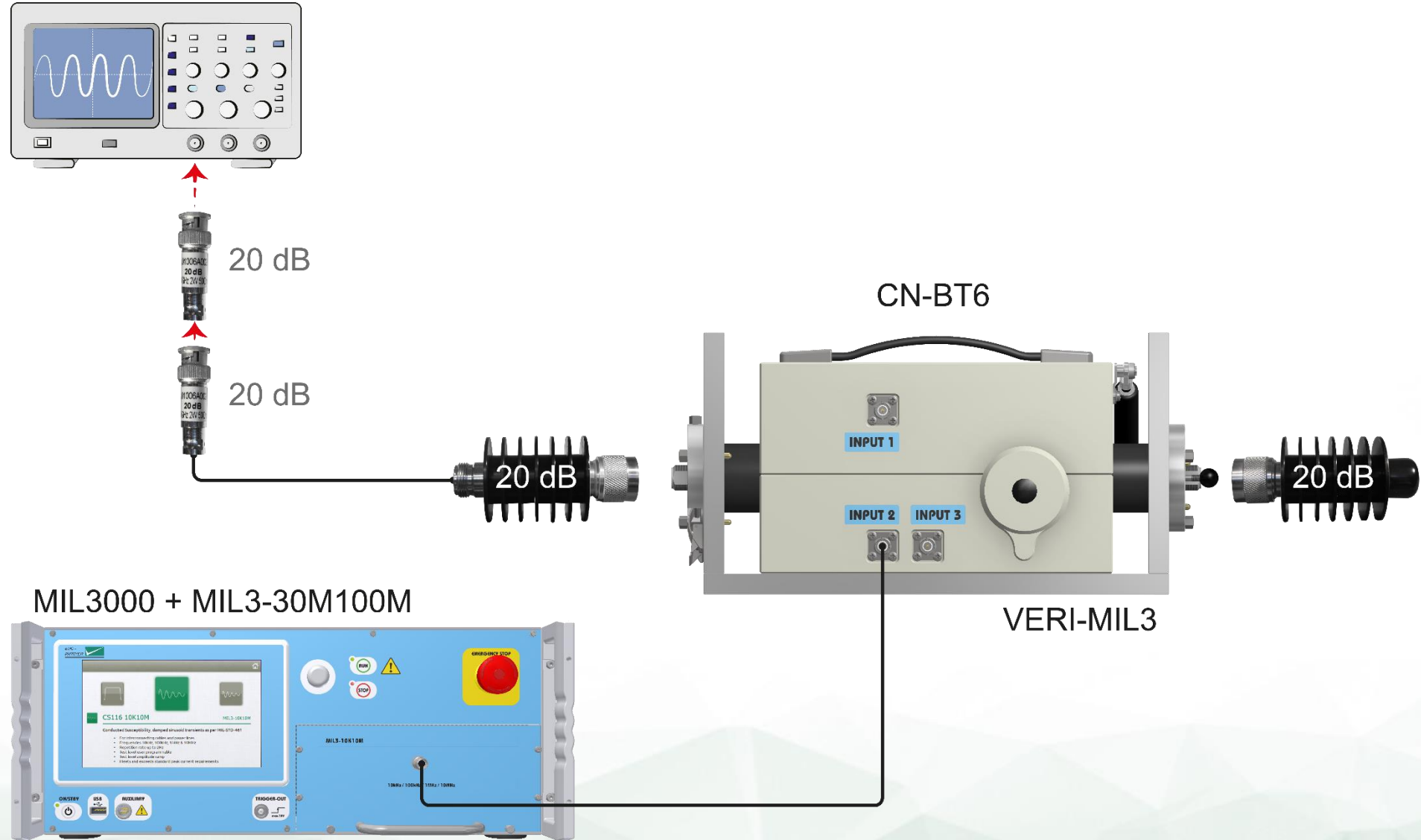

✓ VERI-MIL3 includes both calibration loads (2 x 20 dB/50 Ω) and measurement attenuators (2 x 20 dB/50 Ω)

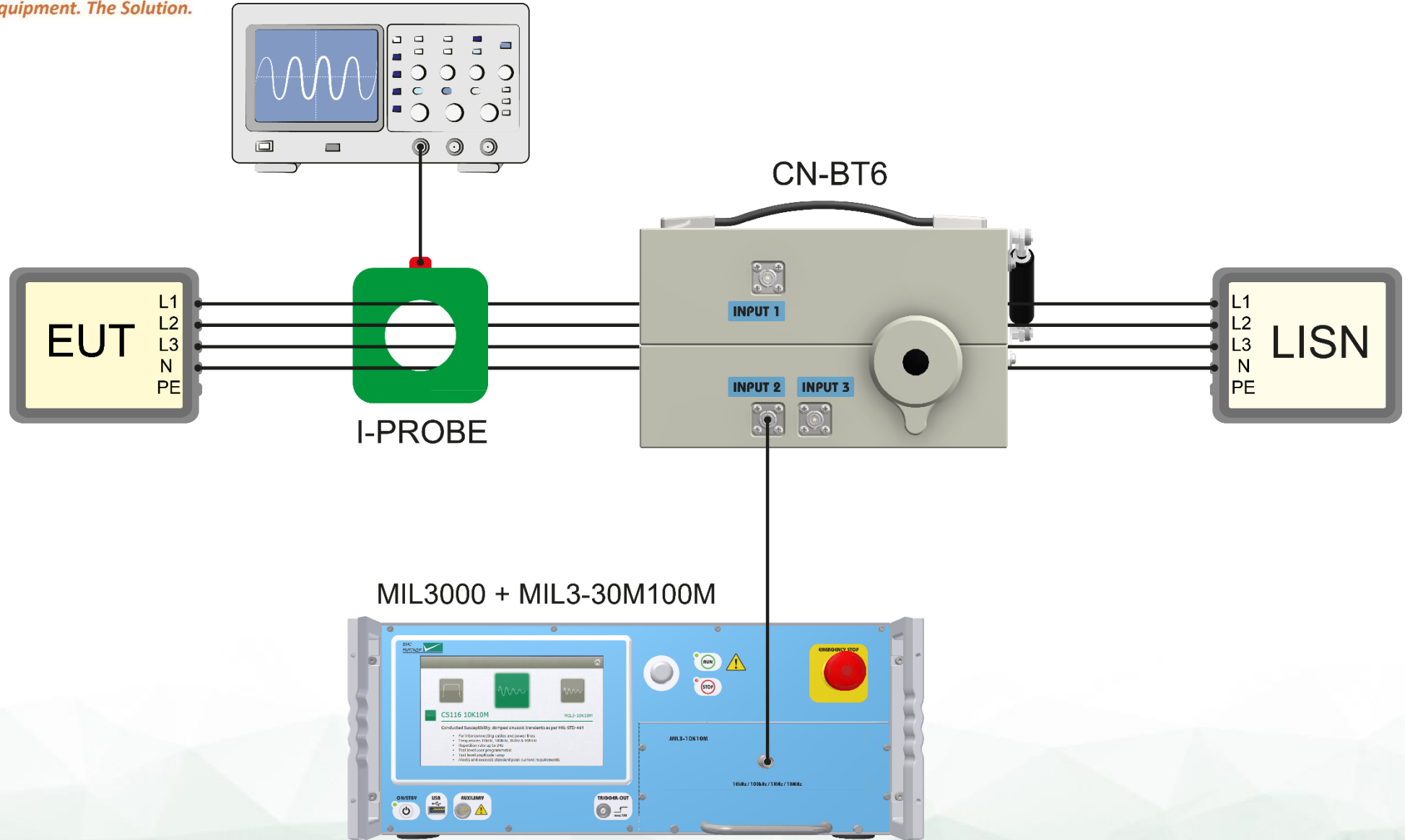

✓ I-PROBE-CS can be used



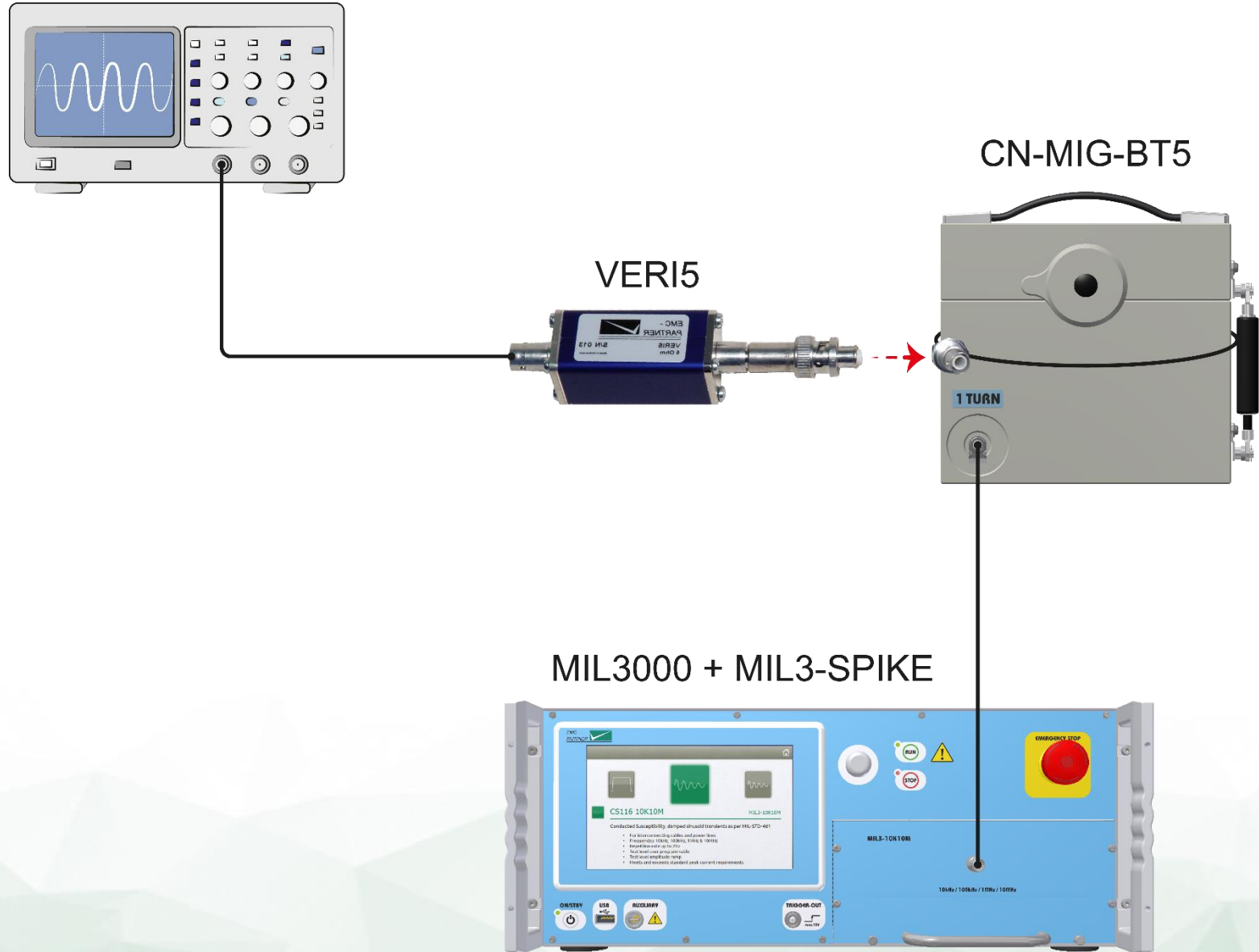

MIL3000 + MIL3-SPIKE

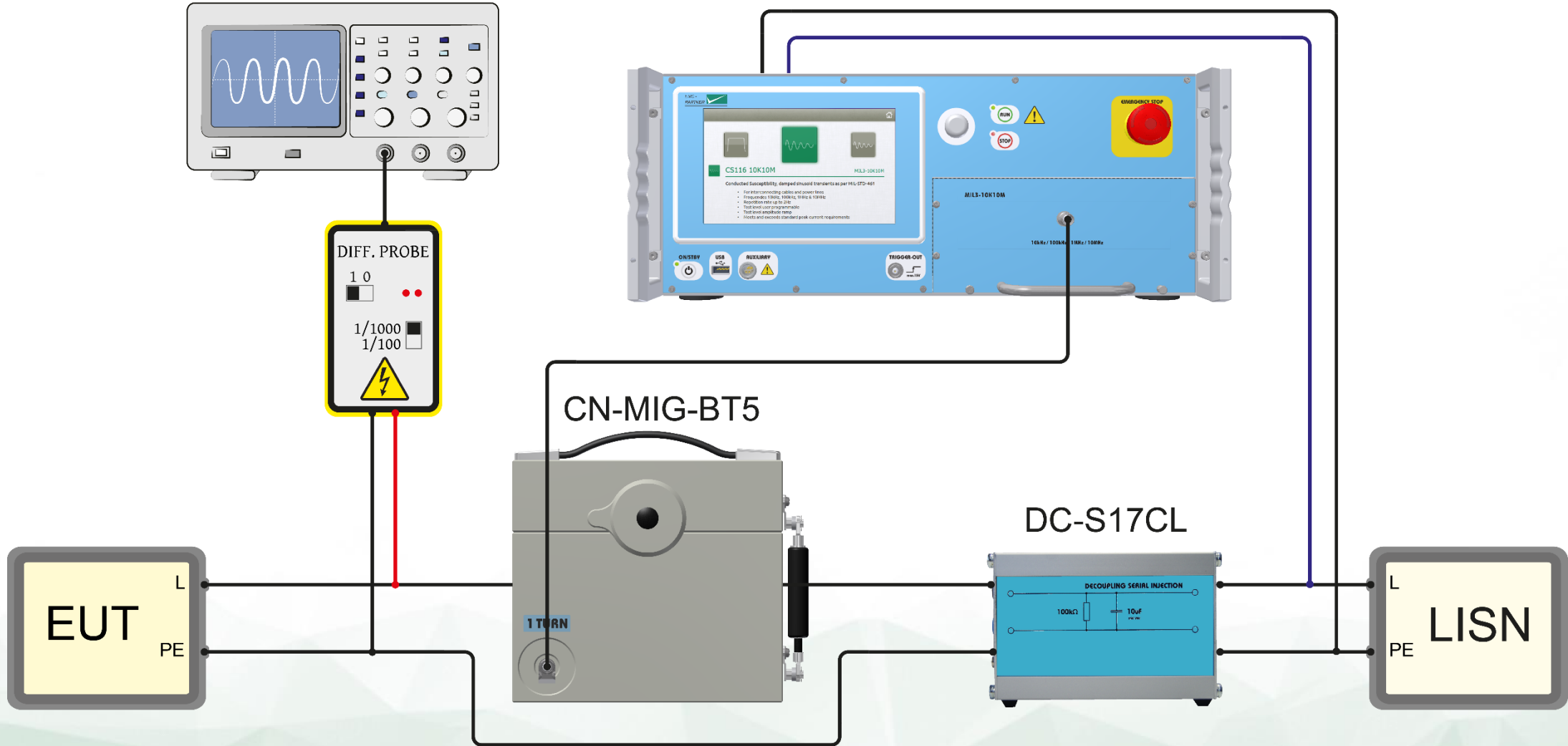

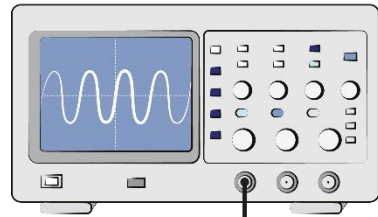

VERI5



CN-MIG-BT5



MIL3000 + MIL3-SPIKE-SLOW

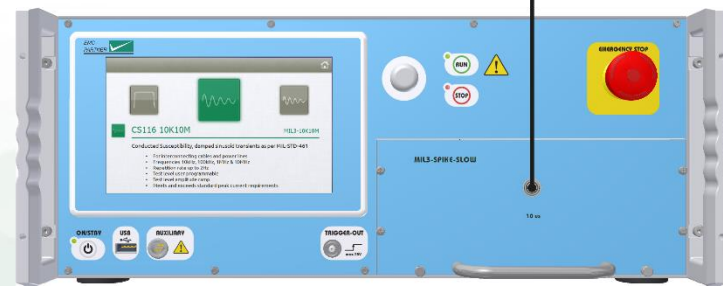

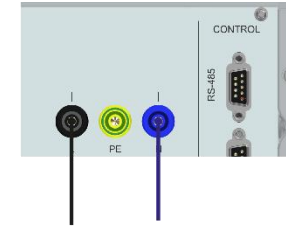

MIL3000 + MIL3-SPIKE-SLOW

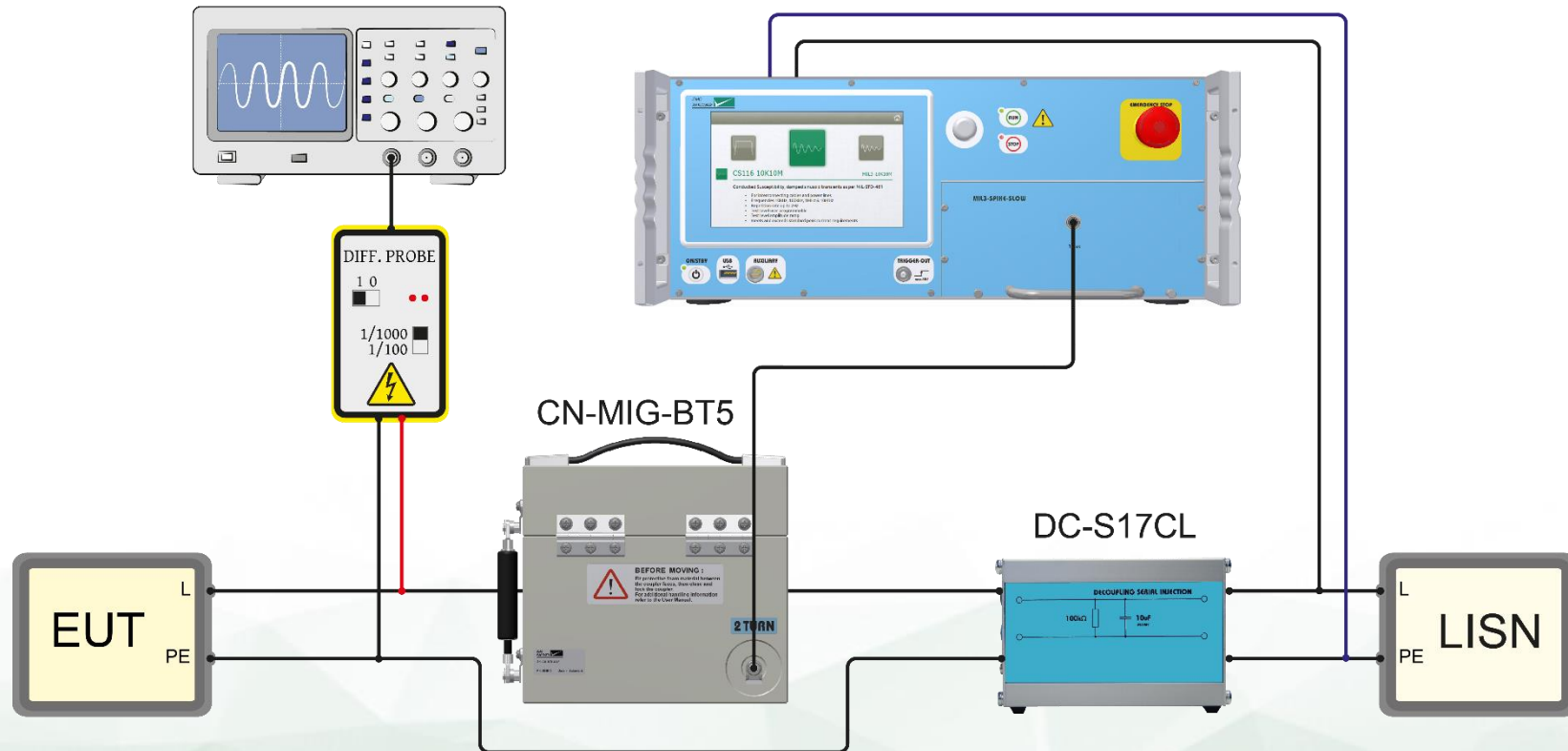

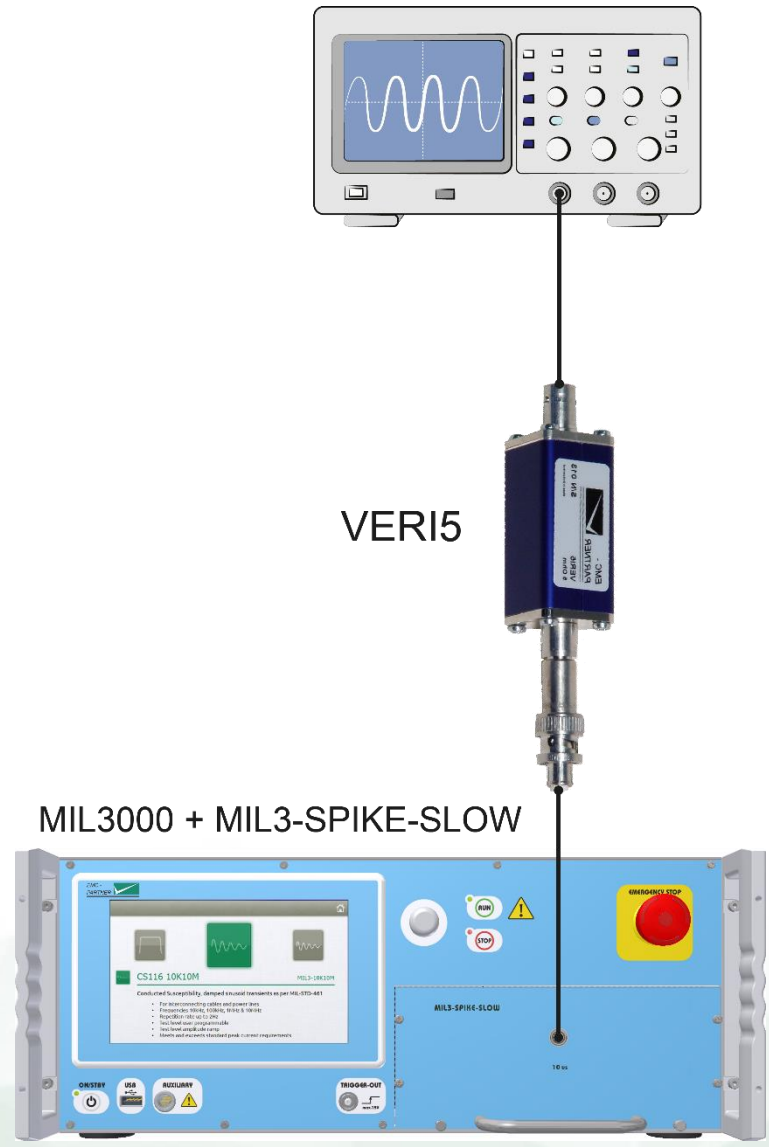

MIL3000 + MIL3-SPIKE-SLOW

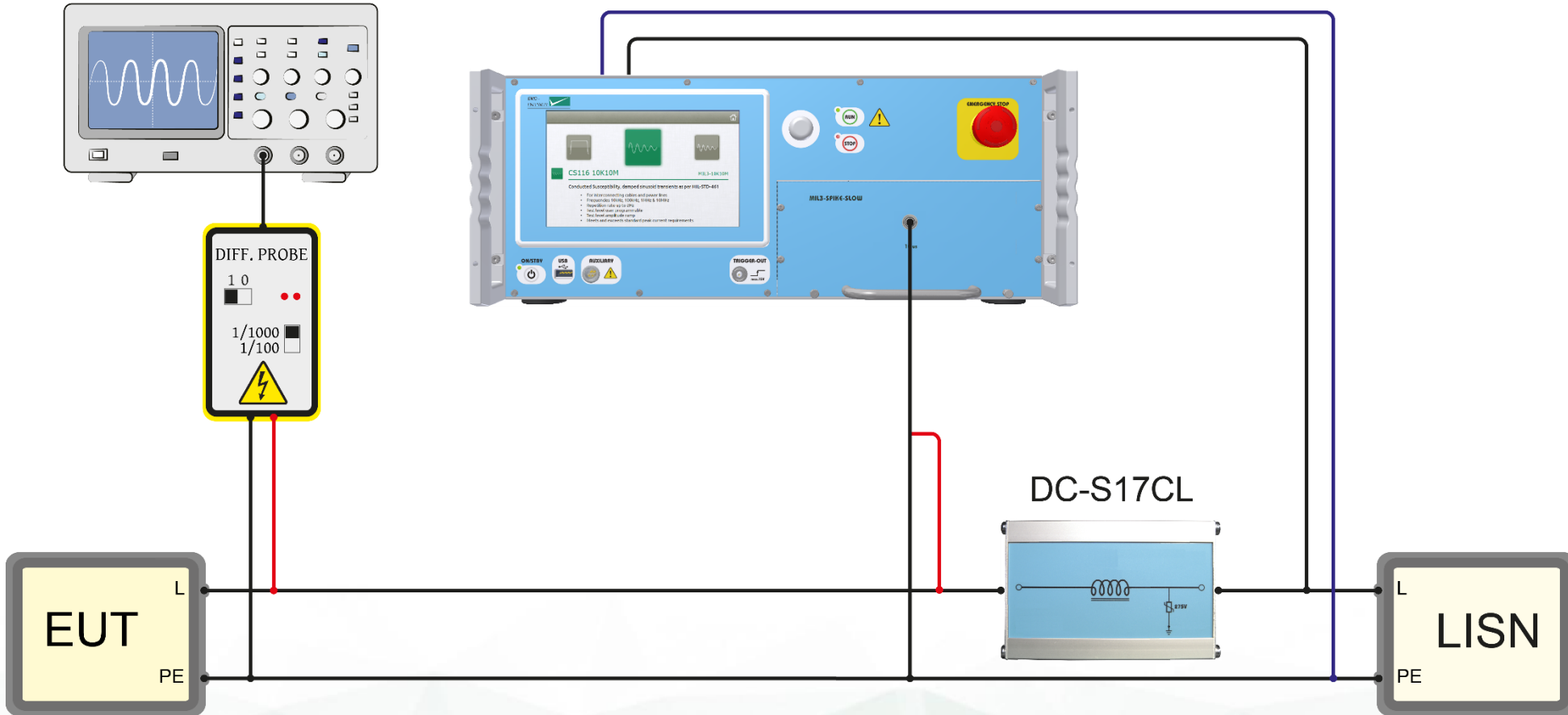

### MIL3000 + MIL3-SPIKE-FAST

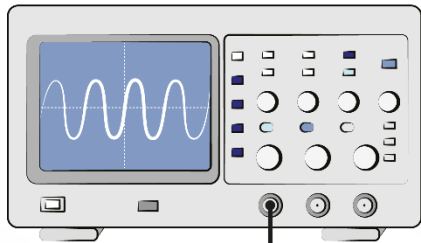
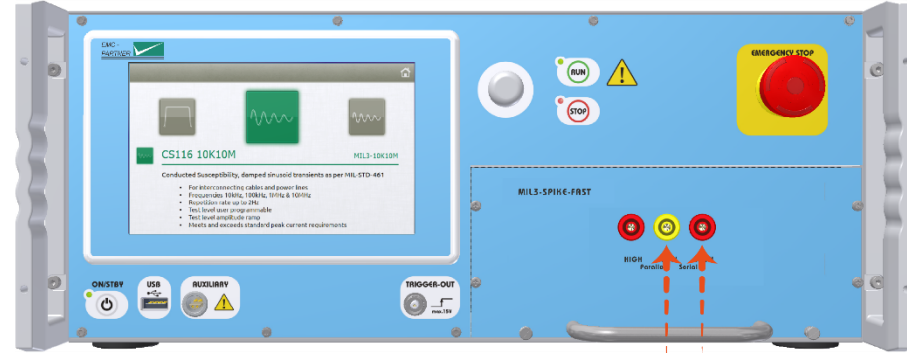

VERI5



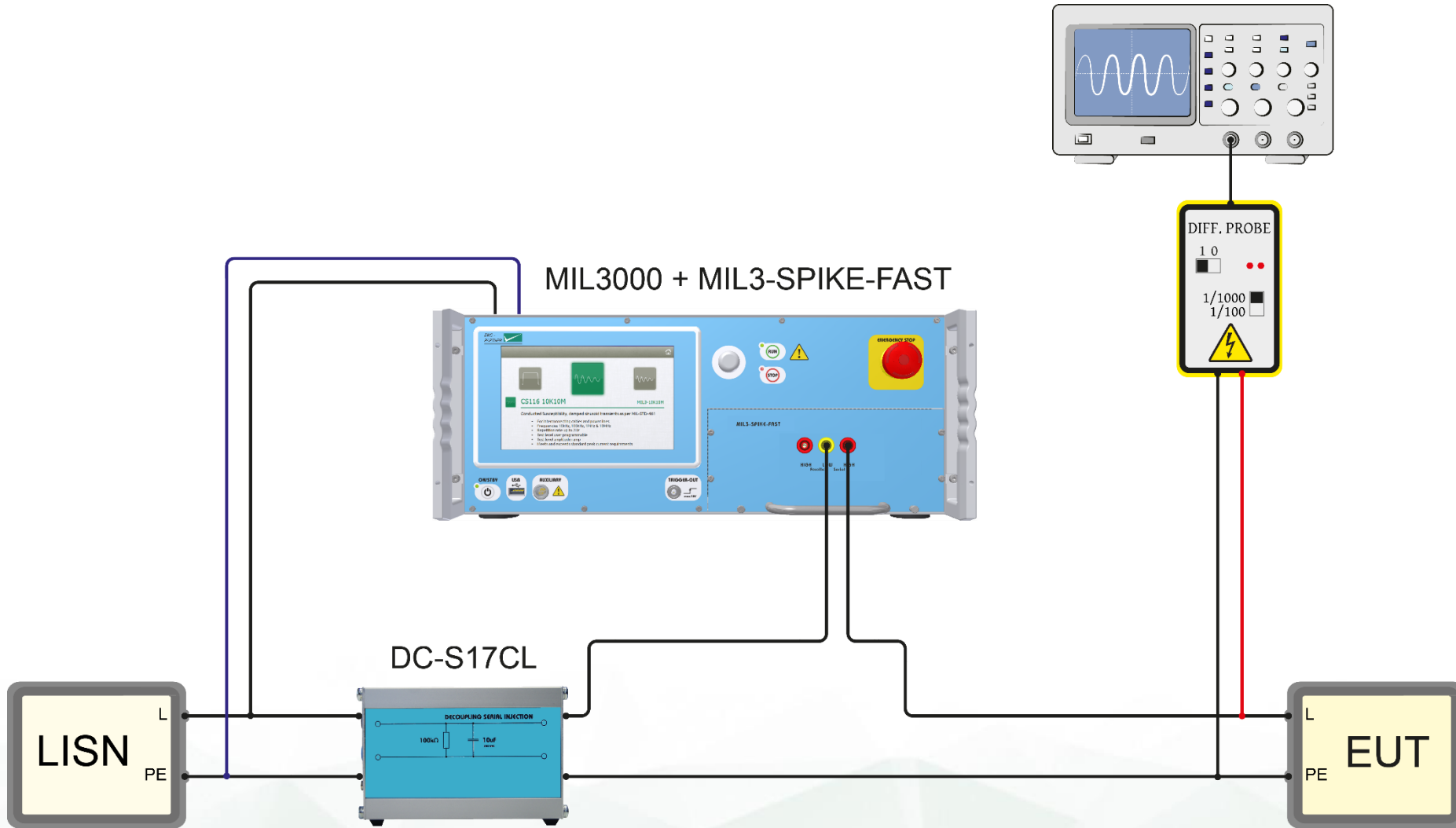



## MIL3000 + MIL3-SPIKE-FAST

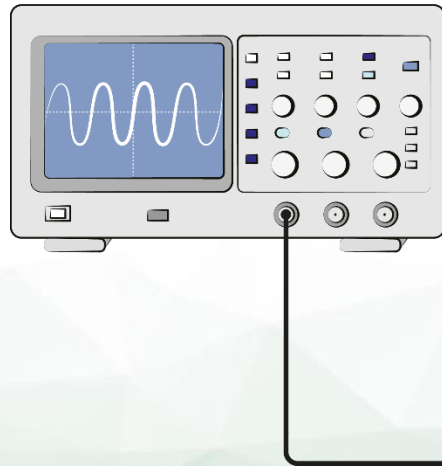
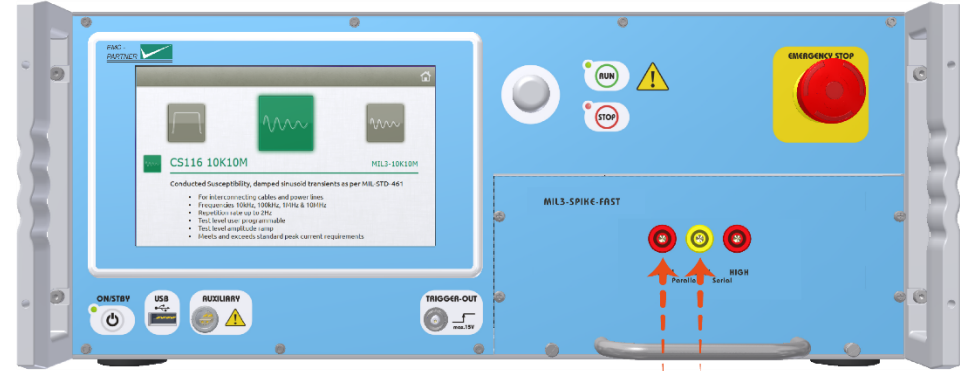

VERI5



MIL3000 + MIL3-SPIKE-FAST

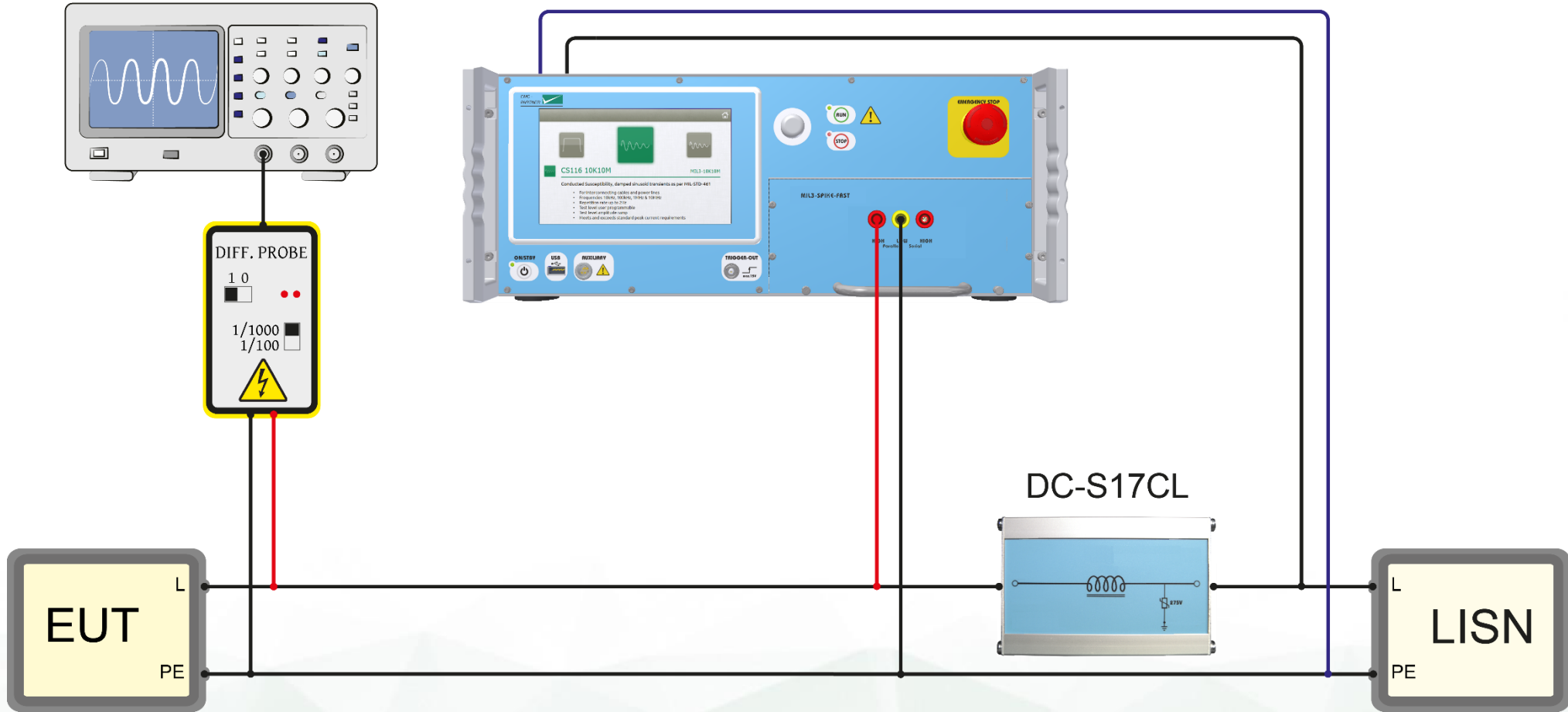

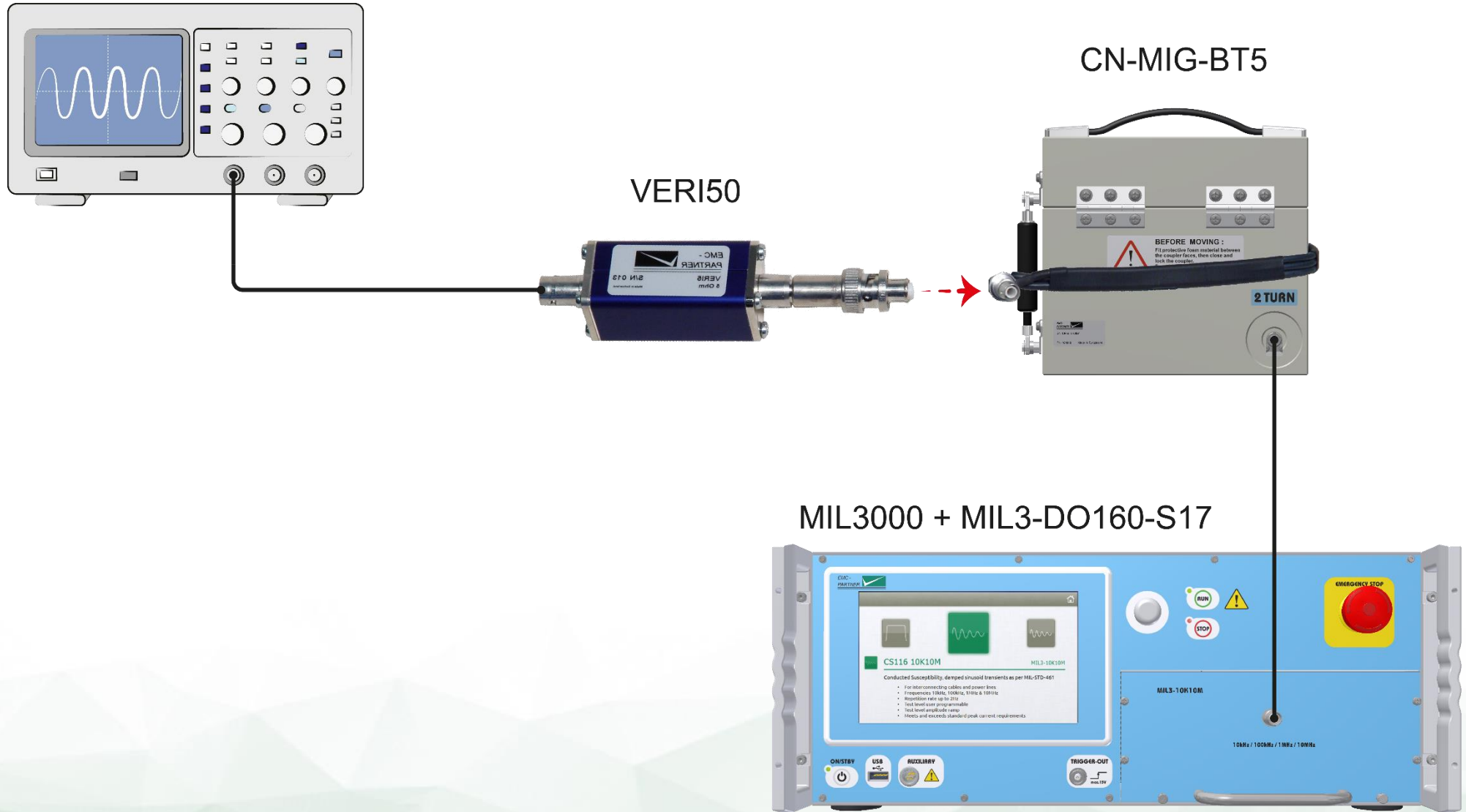

✓ Calibration loop included in delivery

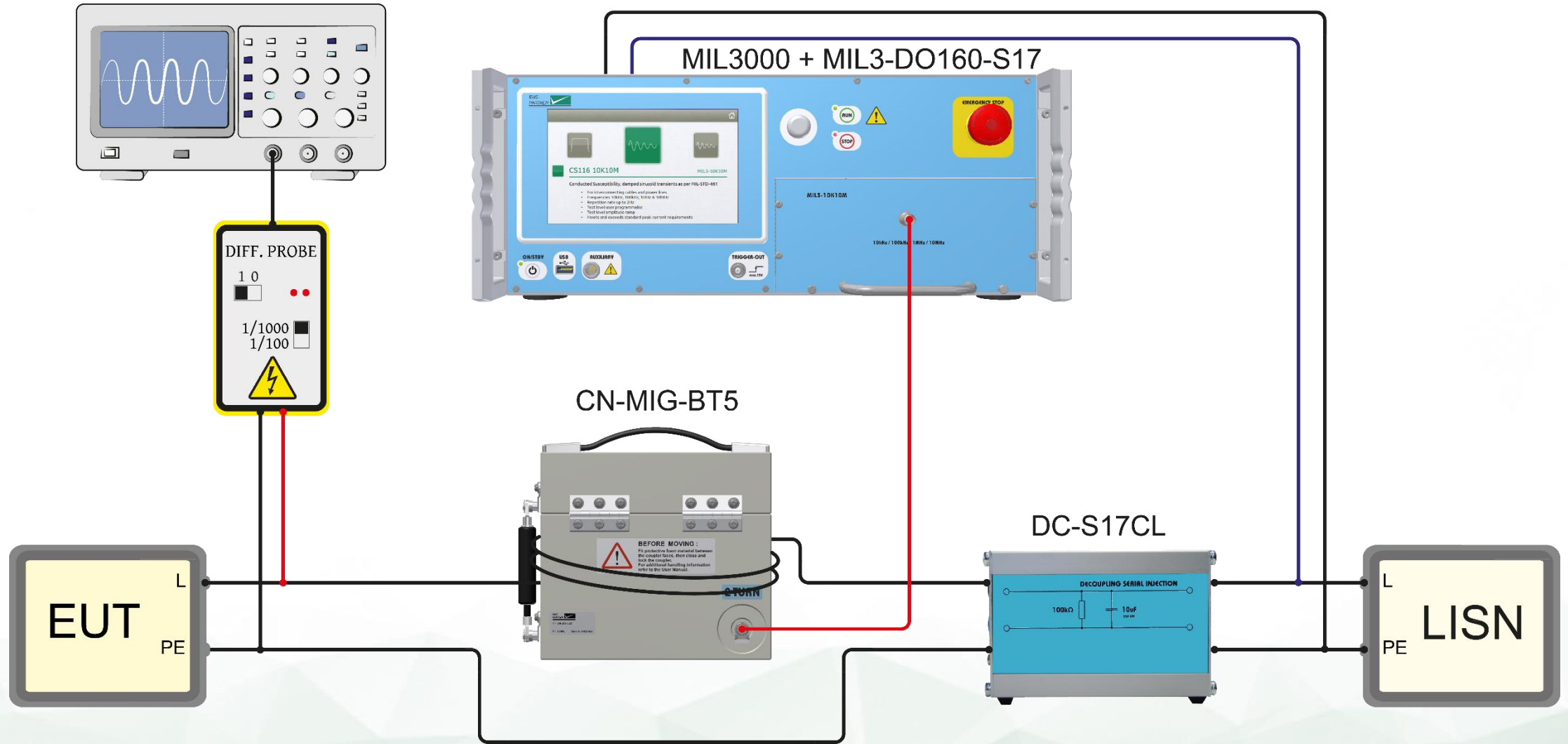

✓ For serial injection, parallel capacitor module(s) from DC-S17CL can be used

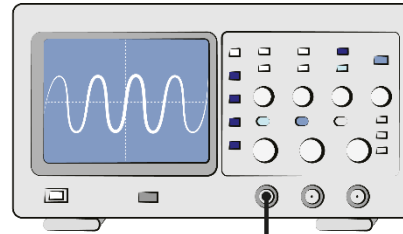

VERI50



MIL3000 + MIL3-DO160-S17

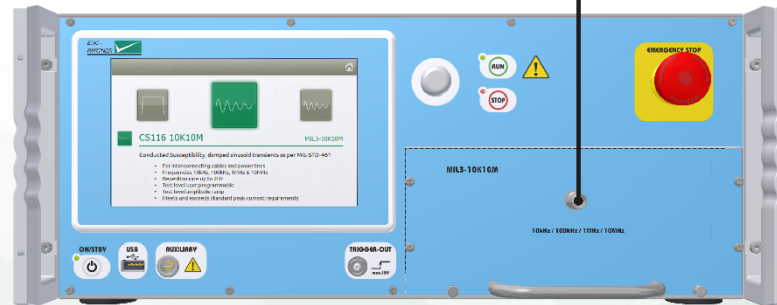

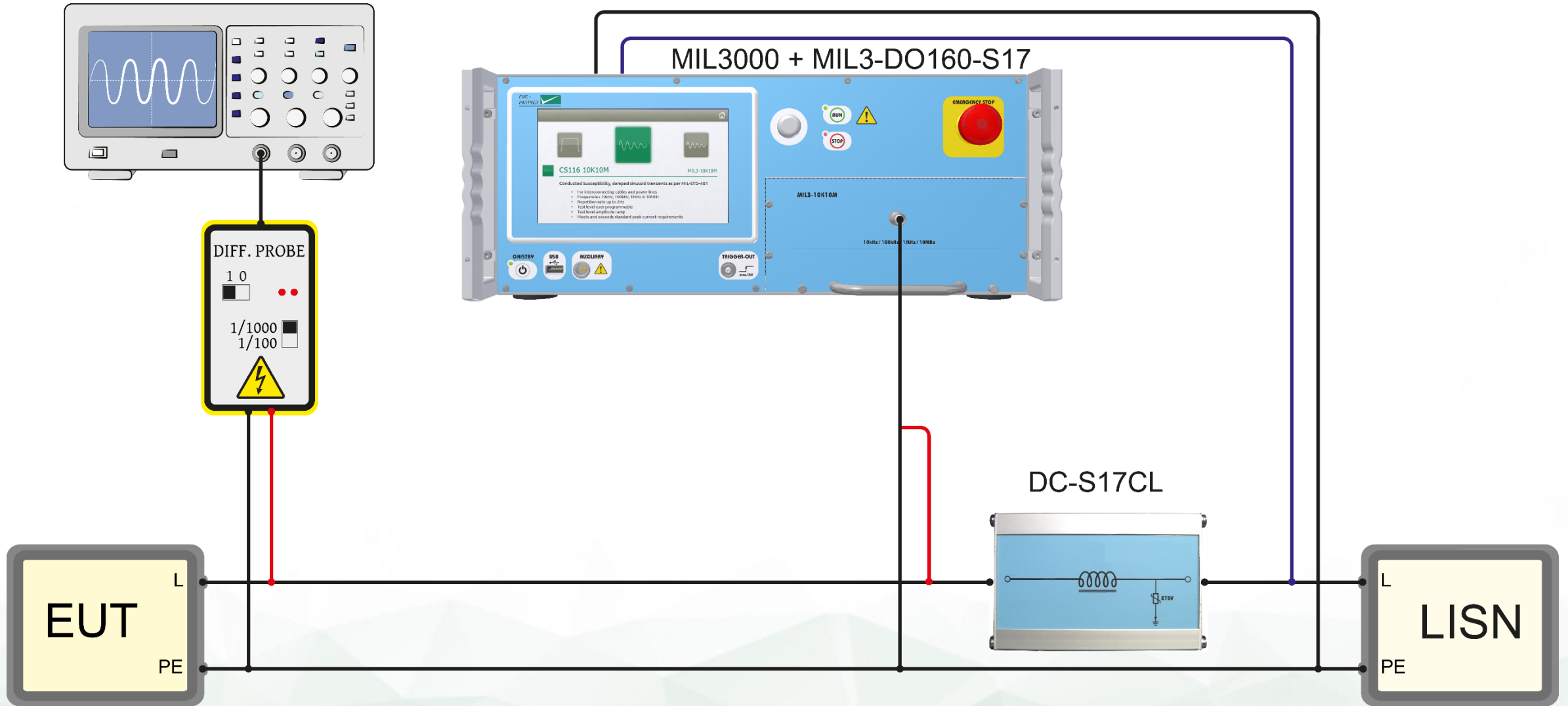

✓ For parallel injection, series inductor(s) from DC-S17CL can be used

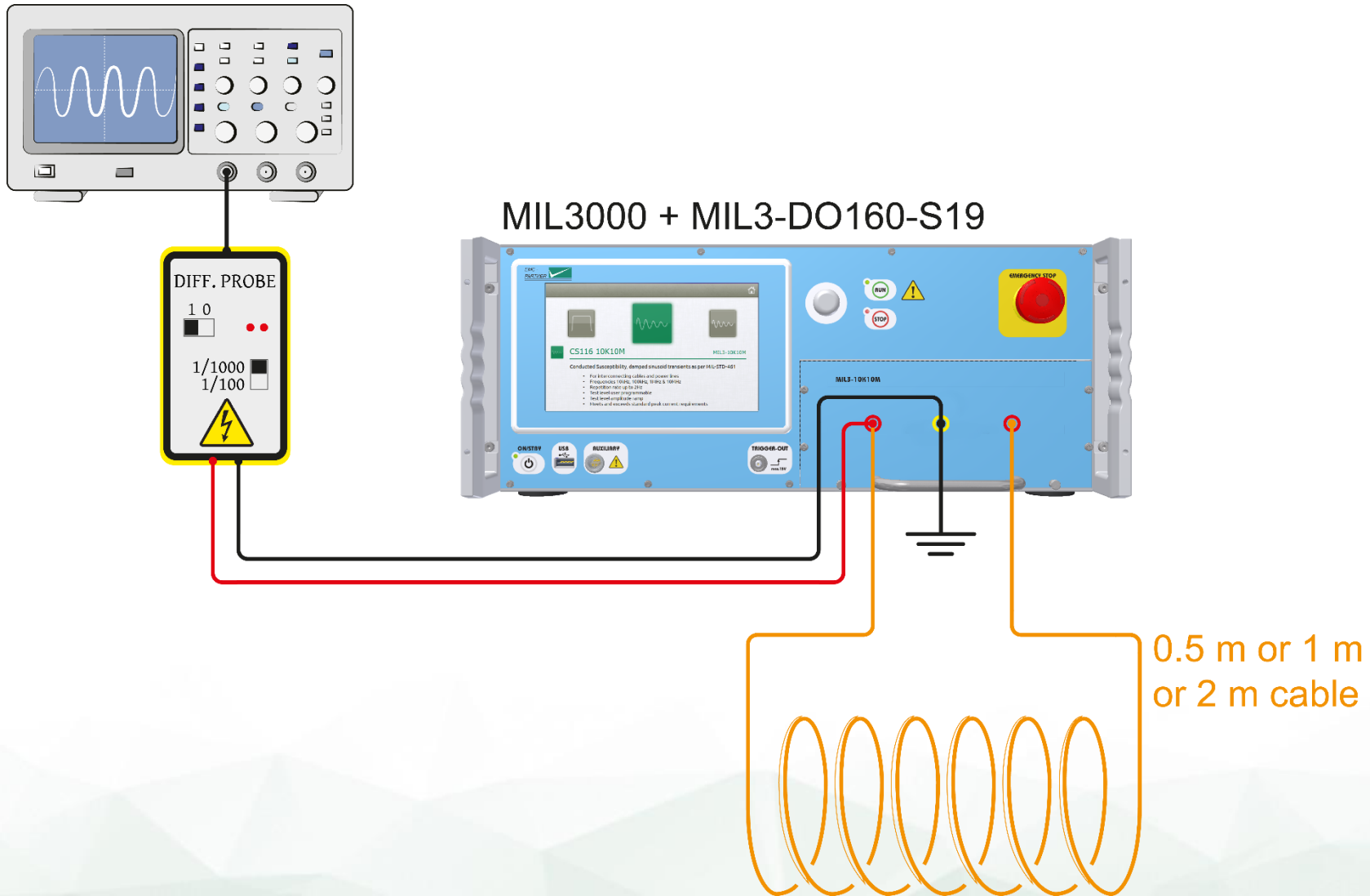

### MIL3000 + MIL3-DO160-S19

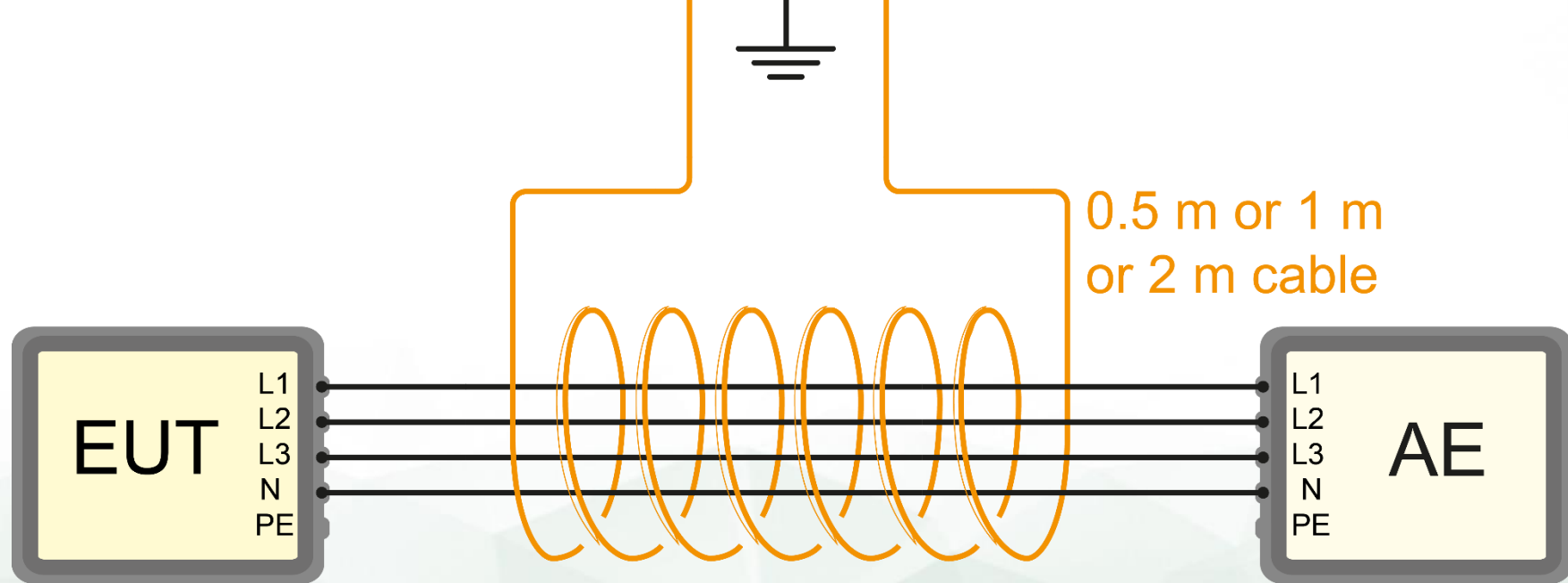
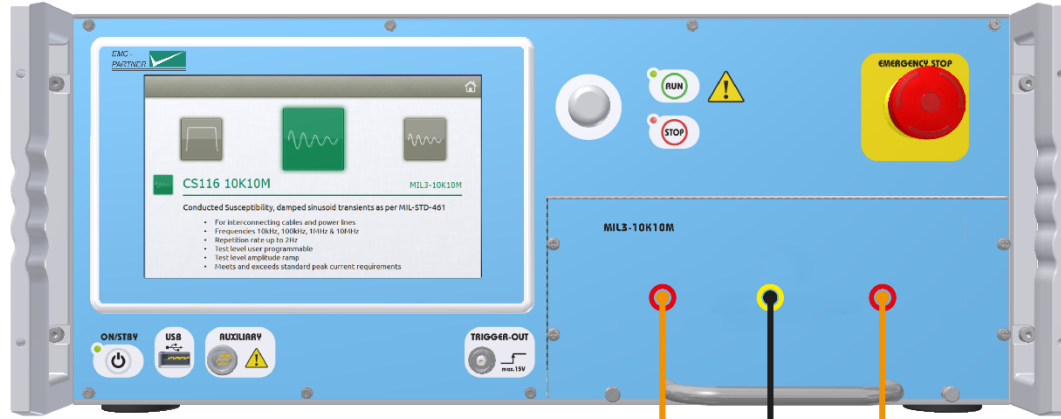



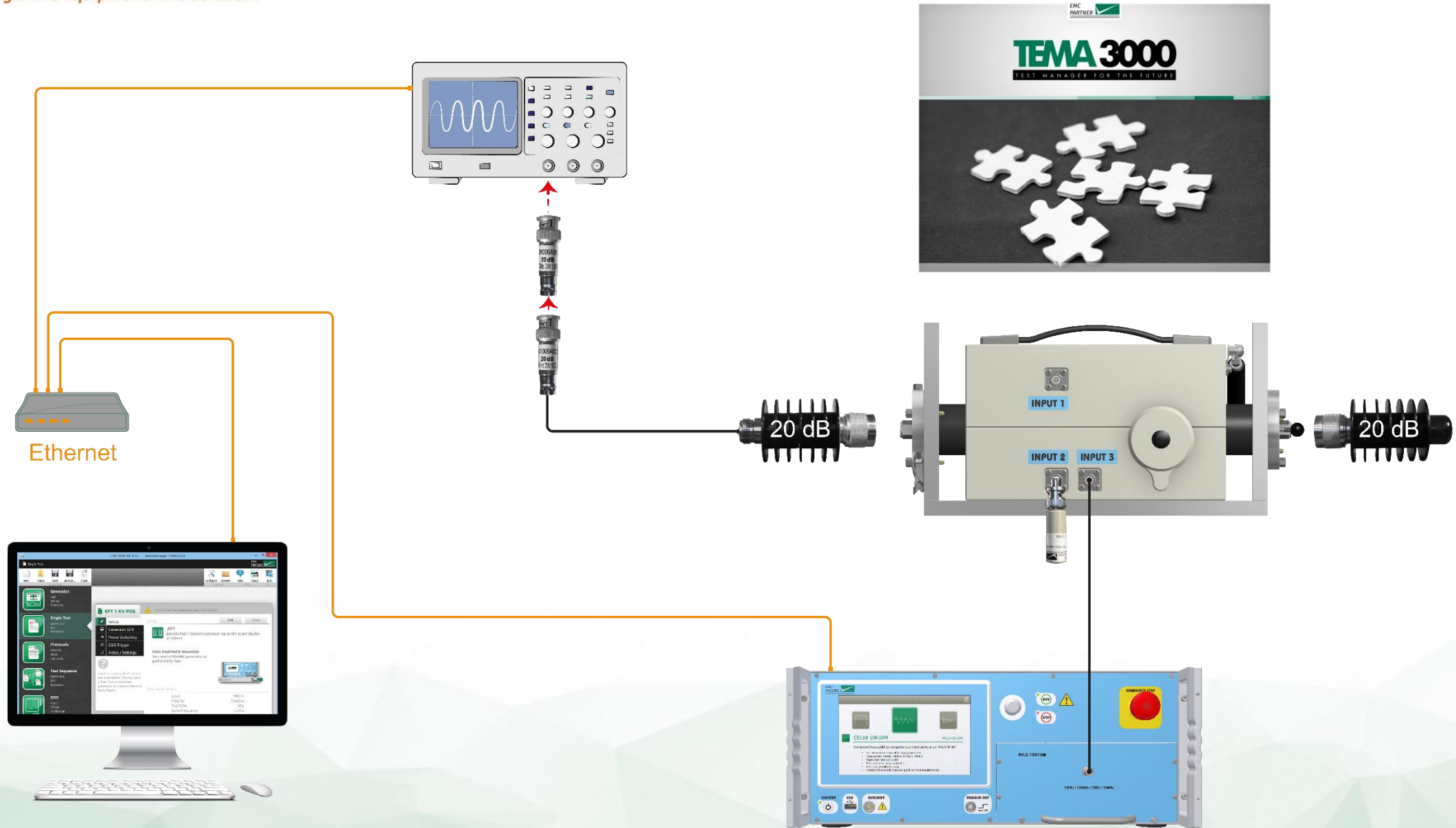

 **Advanced Test  
Equipment Rentals**  
*The Knowledge. The Equipment. The Solution.*

[www.atecorp.com](http://www.atecorp.com)

[www.emc-partner.com](http://www.emc-partner.com)